

Product Repair Bulletin

P/N 696659

Bearing Housing Assembly

NHA: GTCP85 Series APU

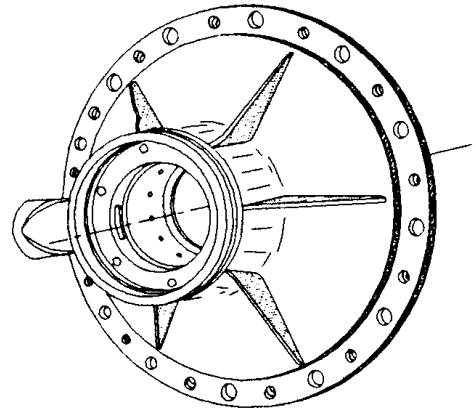

OEM Manual Repairs

Repairs for OEM Manual 49-21-73:

Procure/install H2RA205SC5 flange insert.
 Procure/install S9008A122 pin.(696659-160)
 Weld/dress cracks in strut area.
 Weld cracks in surface M.
 Weld cracks in surface N.
 Metallize diameter D/AB.
 Metallize diameter B.
 Metallize diameter W.
 Metallize surface P.
 Metallize surface R.
 Machine diameter D/AB.

Machine diameter C/AF.
 Machine diameter B.
 Machine diameter W.
 Machine surface P.
 Machine surface R.
 Machine surface M.
 Machine surface N.
 Machine diameter AD.
 Machine diameter AH.
 Grind sleeve I.D (diameter F).
 Grind sleeve I.D.(diameter F) - oversize.

Repairs for Service Bulletins:

Machine body holes. S/B 49-1536 converts 696659-1 to -110.
 Install 12 deswirl vanes. S/B 49-3025 converts 696659-160 to 976979-1.
 Machine scallops in ring. S/B 49-3160 converts 696659[-110/140]/-120/-160 to 977894[-4]/-1/-3.
 Install 2 deswirl vanes per S/B 49-3787 converts 696659-120/-160 to 966578-9/-11.

Additional FAA Approved Repairs

Repairs for Britt Metal Major Repair 9001161:

Fabricate/install -1 Sleeve.	Fabricate/install -5 Sleeve.
Fabricate/install -2 Sleeve.	Fabricate/install -6 Sleeve.
Fabricate/install -3 Sleeve.	Fabricate/install -100 Ring.
Fabricate/install -4 Sleeve.	Metal fuse sleeve bore.

Repairs for Britt Metal Major Repair 9101081:

Fabricate/install -13 Oil Tube and -15 Oil Tube Ring
 Fabricate/install -300 Flange.

Repairs for Britt Metal Major Repair 9106101:

Fabricate/install -50 Hub.
 Machine diameter A.
 Fabricate/install deswirl vane(s).

Modifications for Britt Metal Major Repair 9508231:

Modify P/N 696659-170 to P/N 977894-9MOD.
 Modify P/N 977894-2 to P/N 977894-9MOD.
 Modify P/N 977894-1 to P/N 977894-2MOD.

Product Repair Bulletin

P/N 696659
Bearing Housing Assembly

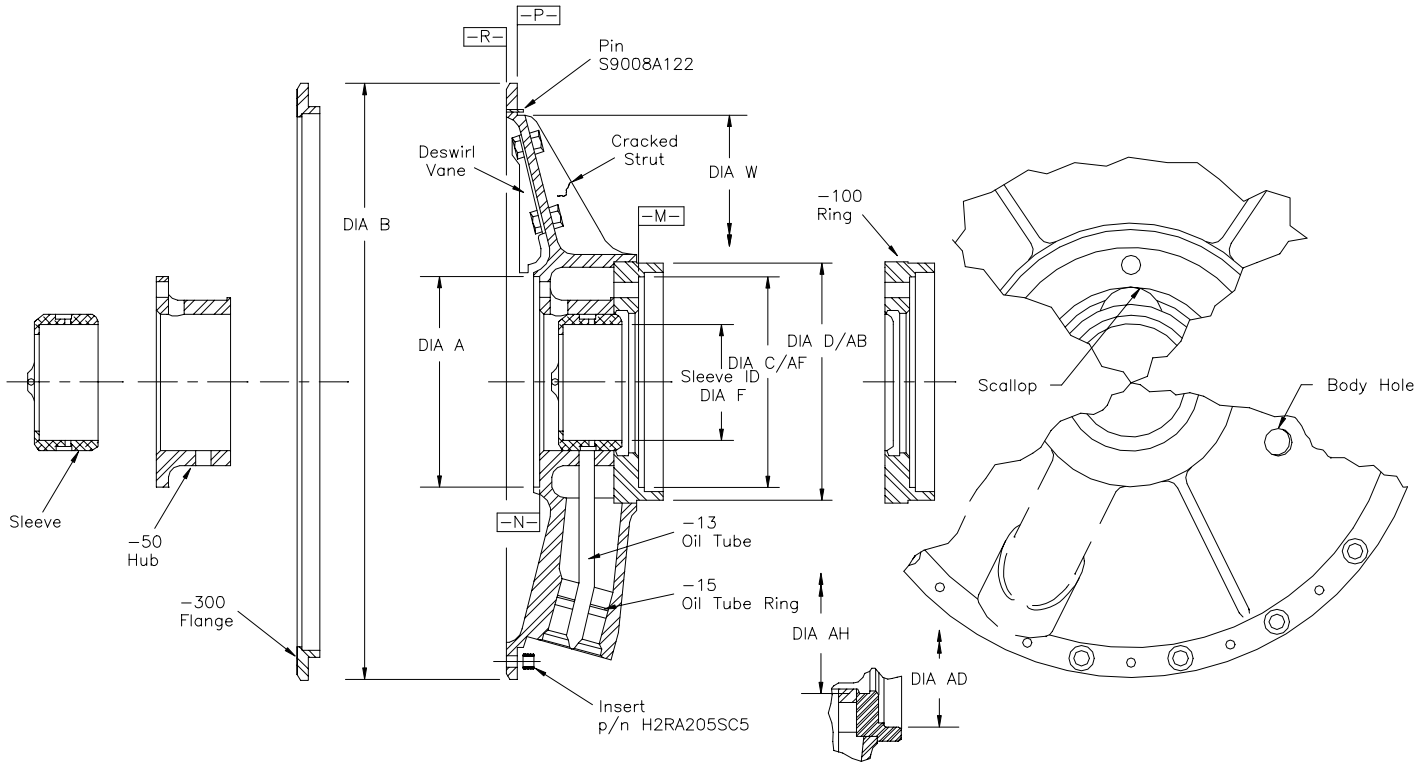

**Bearing Housing
 Feature Reference Chart**

P/N	No Vanes	2 Vanes	12 Vanes	No Piston Ring Groove	Scallops	No Scallops	Flange Pin	No Flange Pin	Body Holes	No Body Holes
696659-110	X			X		X		X	X	
696659-120	X			X		X		X		X
696659-140	X			X		X		X	X	
696659-160	X			X		X	X			X
696659-170		X		X		X		X		X
966578-9		X		X		X		X		X
966578-11		X		X		X	X			X
976979-1			X	X		X	X			X
977894-1	X			X	X			X		X
977894-3	X			X	X		X			X

